

Lake Marion Elementary Addition

Lakeville, MN

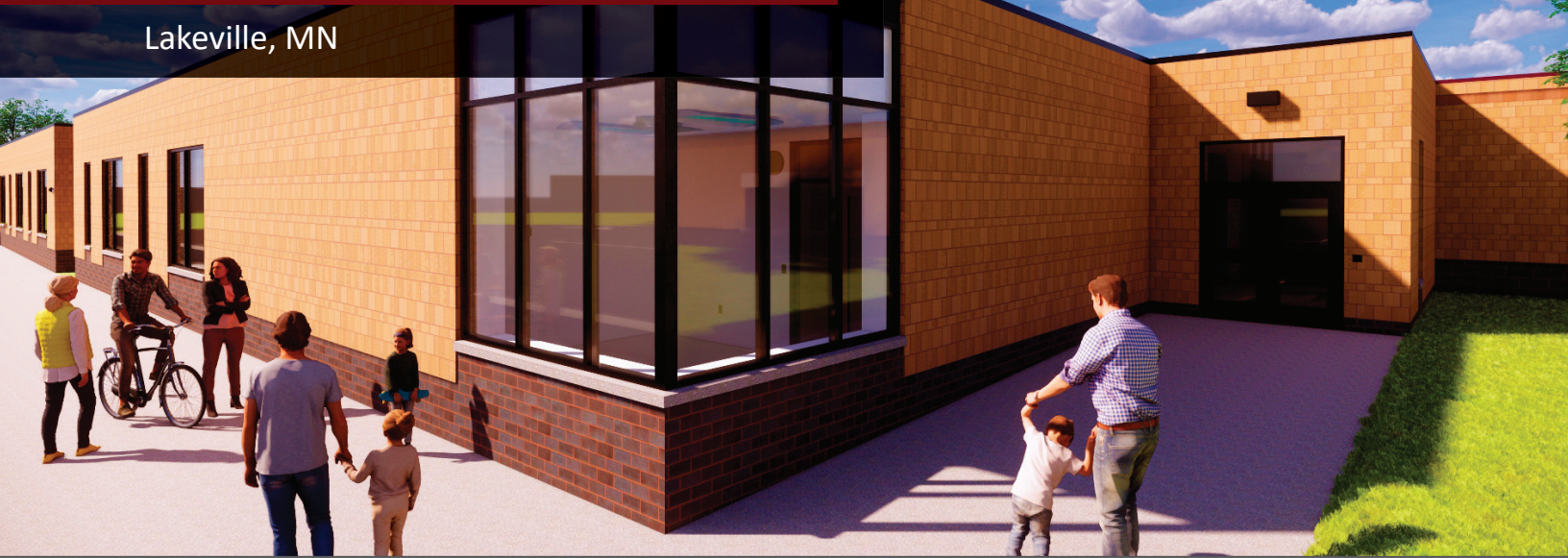

Integrity Built

The project provides a building addition to an existing elementary school. This addition will increase the size of this elementary school by approximately 15,500 SF. The exterior was designed to blend the addition into the existing building to minimize the appearance of being added at a later date. The interior space adds ten additional classrooms plus two small group learning areas. The interior finishes will be updated to the District's new standard.

The project began in February with a final completion date set for August 2020. The District needed the additional classrooms for their continued growth in students. Loeffler developed a CPM schedule for the preconstruction, construction, and closeout which supported the District's final completion requirement. The schedule took into account the long lead items, the bid strategy for public procurement, winter conditions to begin as early as possible, and permitting process. A conditional use permit was required in order to obtain the building permit and subsequent trade permits. Loeffler and the design team worked to produce design documents in support of this process, including the project's review at both the planning commission and city council meeting. The project budget was set prior to the start of design and was not to be exceeded. Loeffler provided bi-weekly estimate updates based on the design as it progressed through each phase and the intermediate versions.



Client - ISD 194

Architect - DLR Group

Construction Cost - \$5.7 Million

Project Size - 15,500 SF

Loeffler Role - Construction Manager Advisor